



■ Description

The FFH-2EV detector units are the “heart” of many Fire Protection Systems.

The FFH-2EV detector units have met with wide acceptance because they are designed with RATE COMPENSATION. This provides a unique advantage over both fixed temperature and rate-of-rise types of detectors because only the FFH-2EV unit accurately senses the surrounding air temperature regardless of the fire growth rate. At precisely the predetermined danger point, the system is activated.

Fixed temperature detectors must be completely heated to alarm temperature and therefore a disastrous lag in time may occur with a fast rate fire. Rate-of-rise devices, on the other hand, are triggered by the rate of increase in ambient temperature and are subject to false alarms caused by harmless, transient thermal gradients such as the rush of warm air from process ovens.

■ Features

- Rate-Compensation Heat Detector
- Versatile - offers various temperature settings 60°C, 70°C, 80°C, 90°C, 100°C, 120°C, 150°C
- Durable - long lasting stainless steel shell
- Contact capacity 30VDC, 100mA

■ Operating Principle

The secret of the unit’s sensitivity is in the design (Figure 1). The outer shell is made of a rapidly expanding alloy which closely follows changes in surrounding air temperature. The inner struts are made of a lower expanding alloy. Designed to resist thermal energy absorption and sealed inside the shell, the struts follow temperature changes more slowly.

A slow rate fire (Figure 2) will heat the shell and struts together. At the “set point,” the unit will trigger, actuating the alarm or releasing the extinguishing agent.

A transient rush of warm air may expand the shell, but not enough to trigger the unit. By ignoring transient warm air excursions, the FFH unit virtually eliminates false alarms prevalent with rate-of-rise devices.

If a fast rate fire (Figure 3) starts, the shell will expand rapidly. The struts will close, actuating the alarm or releasing the agent. The faster the fire rate of growth, the sooner the FFH unit will react.

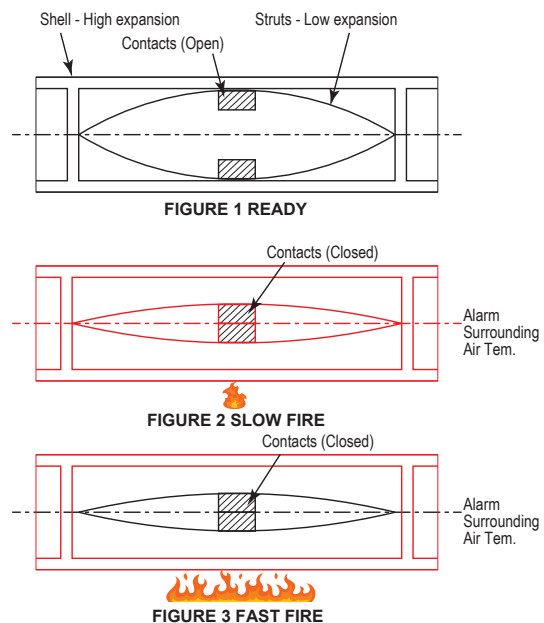

■ Dimensions

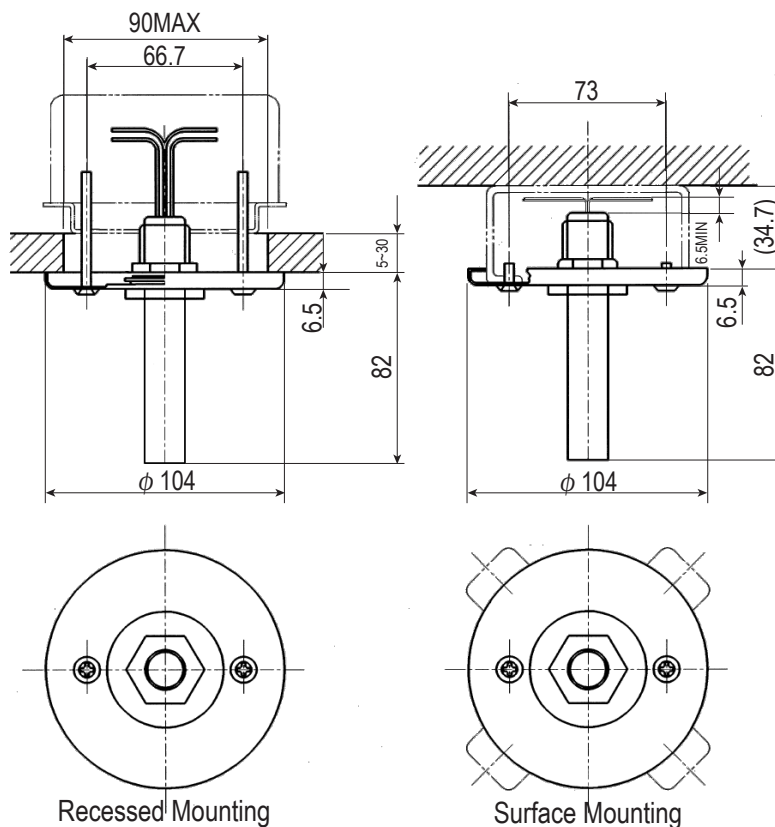

■ Ordering Information

Model Name	Description
FFH-2EV060	Rate-Compensation Heat Detector (Vertical Type/ 60°C)
FFH-2EV070	Rate-Compensation Heat Detector (Vertical Type/ 70°C)
FFH-2EV080	Rate-Compensation Heat Detector (Vertical Type/ 80°C)
FFH-2EV090	Rate-Compensation Heat Detector (Vertical Type/ 90°C)
FFH-2EV100	Rate-Compensation Heat Detector (Vertical Type/ 100°C)
FFH-2EV120	Rate-Compensation Heat Detector (Vertical Type/ 120°C)
FFH-2EV150	Rate-Compensation Heat Detector (Vertical Type/ 150°C)
FHT-3E	Heat Detector Tester for FFH heat detector

■ Specifications

Specifications	FFH-2EV
Classification	1st Class, Vertical type
Contact Capacity	DC30V, 100 mA
Lead Wire Length	200 mm $\pm 10\%$
Weight	Apx. 190 g
Operating Temperature Range	60°C, 70°C, 80°C, 90°C, 100°C, 120°C, 150°C

All specifications are subject to change without any notice.
For more information, contact with NITTAN.

NITTAN

54-5, 1-chome, Sasazuka,
Shibuya-ku, Tokyo 151-8535, Japan
TEL: +81-3-6407-9861 FAX: +81-3-5465-5077

Distributed By